

Office Space

The following table indicates the office standards by which Campus Facilities – Space Planning & Management Space Analysis information is generated:

Group Description	Office/ Cubicle Size Sqft.
Faculty - Office Based	140 - 160
Faculty - Clinic or Laboratory Based	120 - 160
Other Teach & Res Staff	120 - 150
**GTA's/GRA's	64 - 80
Executive/Admin	150 - 200
Professional	125 - 135
Non-Exempt Technical	100 - 125
Non-Exempt Office/clerical	81 - 100
Non-Exempt Crafts & Trades	by need
Non-Exempt Service	by need
**Student Employees	36 - 64

*-AAU members: Iowa Stet Univ., The Ohio State Univ., Purdue Univ, Texas A&M, Univ of California-Berkley, Univ of Colorado-Boulder, The Univ of Kansas, Univ of Nebraska, Univ of Oregon, The Univ of North Carolina – Chapel Hill

** -Individual offices or offices with multiple student offices.

Classroom/ Class Labs

Classrooms and Class Laboratories Space Guidelines:

Room Type	# of Stations		NASF/ Station		
			Low	Medium	High
Seminar room-movable table and chairs	0	20	20	28	31
Discussion Classroom -fixed tables and chairs	20	35	18	23	25
Discussion Classroom -fixed tables and chairs	20	35	21	25	28
Discussion Classroom -fixed tablet arm	25	60	16	18	20
Discussion Classroom - movable table and chairs	25	60	18	20	22
Lecture Hall-fixed tablet arm	60	150	16	18	20
Lecture Hall- fixed table movable chairs	60	150	22	24	26
Lecture Hall-fixed tablet arm	150	250	15	17	19
Lecture Hall-fixed tablet arm	250	300	14	16	18
Lecture Hall-fixed tablet arm	300	500	14	15	17
Computer Classroom	20	40	35	35	39
Distance Learning	25	30	27	30	33

Class Laboratory Support space ranges from 14% to 52% of the total class lab space depending on the discipline.

Research Space

Research Lab Space Guidelines by station size and discipline.

Discipline Categories	Disciplines
Intensive: 300 ASF average per research station	Agricultural Sciences, Animal Sciences, Biological Sciences, Forestry, Engineering, Physical Sciences, Marine Sciences, Textiles, and Veterinary Medicine
Moderately Intensive: 125 ASF average per research station	Computer Science, Design and Psychology
Non-Intensive: research done at the working station (office setting); an additional 15 ASF average per station is needed.	Education, Communications, Language, Social Sciences, Business & Economics, Mathematics and Statistics

Research module example sizes:

Module Dimensions	Area (SF)
30'-0" x 11'-0"	330
30'-0" x 10'-6"	315
30'-0" x 10'-0"	300

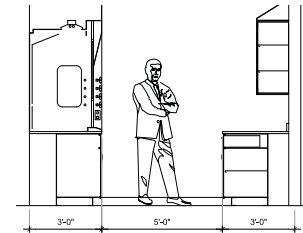

Research Support: based on a percentage of research space, generally 25%-35%.

Animal Space – use published standards.

Space Analysis Guidelines – *Guide for the Care and Use of Laboratory Animals*.

Central Storage – based on a percentage of the space within a department/division depending on the discipline and specific program requirements.

This document focuses more on the generic types of space in campus. The rest of the facilities tend to have more specific requirements and because of that they were not incorporated in this document although CF-Space Planning and Management develops guidelines as needed during studies.